

**New Working  
New Living**

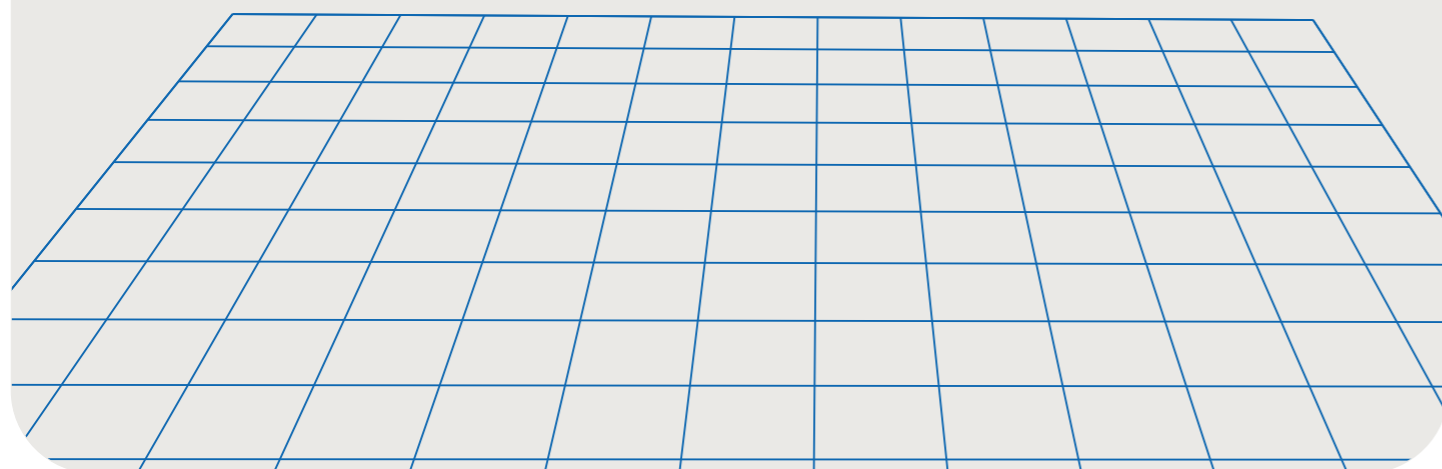

# FlexiSpot

Item No. SK2  
User Manual

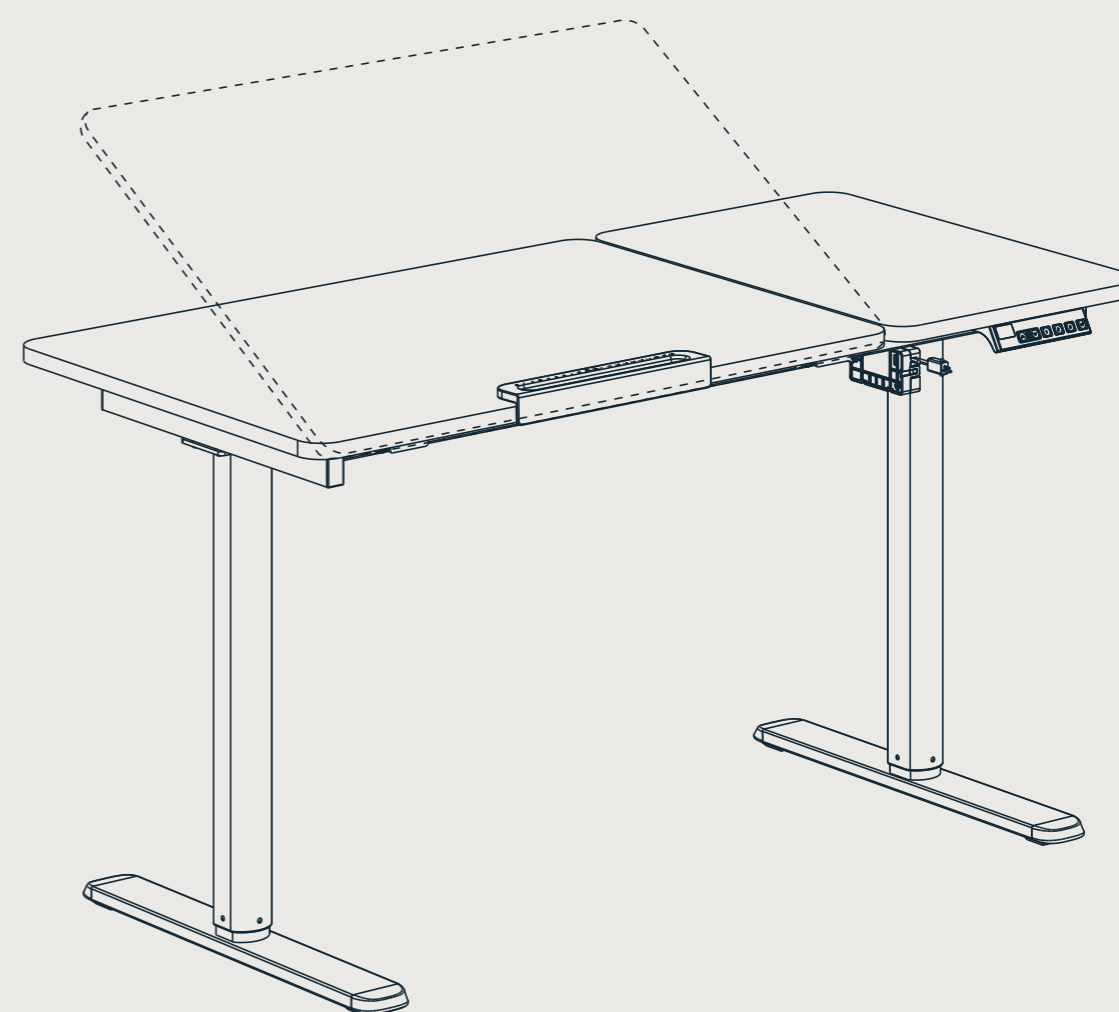

# Specifications

Column stage	2
Max. Load Capacity	50KG
Max. Speed	15mm/s
Lowest Height	585mm
Highest Height	905mm
Flip Angle	0 ~ 40°
Applicable Tabletop Size	1100mmx520mm

The product has been designed to meet Commission Regulation with regard to ecodesign requirements for electric power consumption of Low power consumption mode condition of electrical and electronic household equipment.

The technical information of Low power consumption mode condition:

Mode	Power consumption (Watts)	The period(Minutes)
Low power consumption mode condition	≤0.5W	1min

The website URL of the English - version electronic instruction manual:  
[https://drive.google.com/drive/folders/1vxif76mX8uDxDBwxYSjkggMxcNU8g\\_X\\_?usp=sharing](https://drive.google.com/drive/folders/1vxif76mX8uDxDBwxYSjkggMxcNU8g_X_?usp=sharing)

Power Supply	
Manufacturer: Shenzhen Green Power Electronic Technology Co.,Ltd.	
Model: GRP-30W290010-CE	Average Active Efficiency: ≥86.85%
Rated Input: 100-240VAC,50/60Hz ,0.8A	Efficiency at Low Load (10%): 83.36%
Rated Output: 29.0VDC,1.0A ,29.0W	No-load Power Consumption: ≤0.10 W

# Assembly Notes

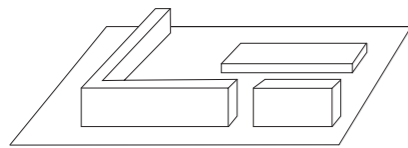

Installation need be done on a carpet to prevent scratches.

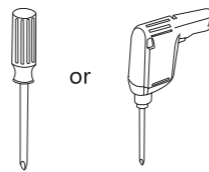

Installation will require a Phillips screwdriver or pistol drill.

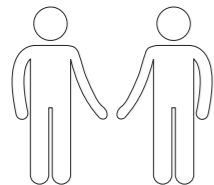

Installation must be done by at least two people.

# Product List

## Accessory Package

Note: The line drawings below are for reference only and may differ slightly from the physical product in some cases. Please refer to the actual product for accuracy . If any tools are missing or there are problems with installation, please contact customer service.

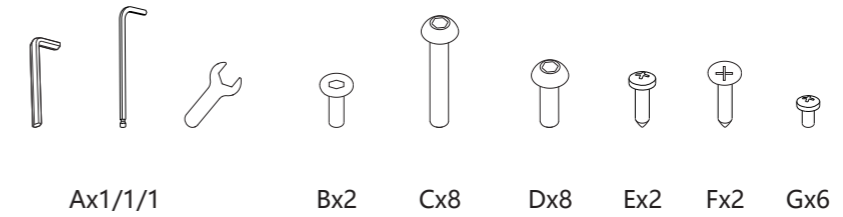

## Parts Included

No.	Part	No.	Part
①	Book Stopper x1	⑦	Pedestal x2
②	Tabletop x1	⑧	Motor (with handset) x1
③	Transmission rod x1	⑨	Hook x1
④	Baffle x3	⑩	AC power cable x1
⑤	Left column x1	⑪	Cable clip x4
⑥	Right column x1		

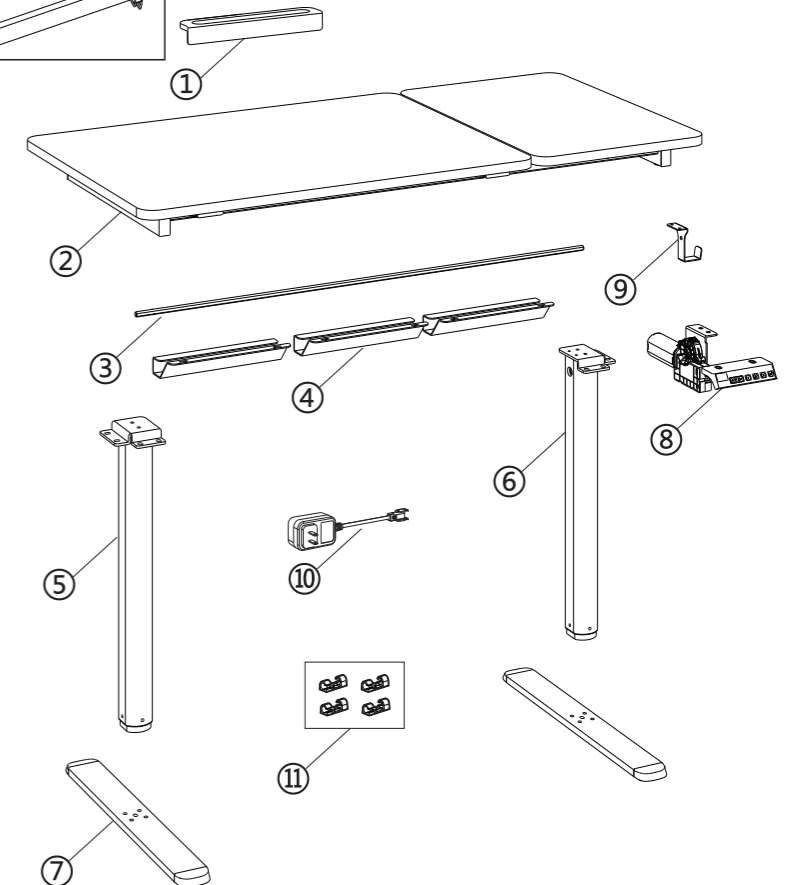

# Assembly Steps

## STEP1

Install the Hook

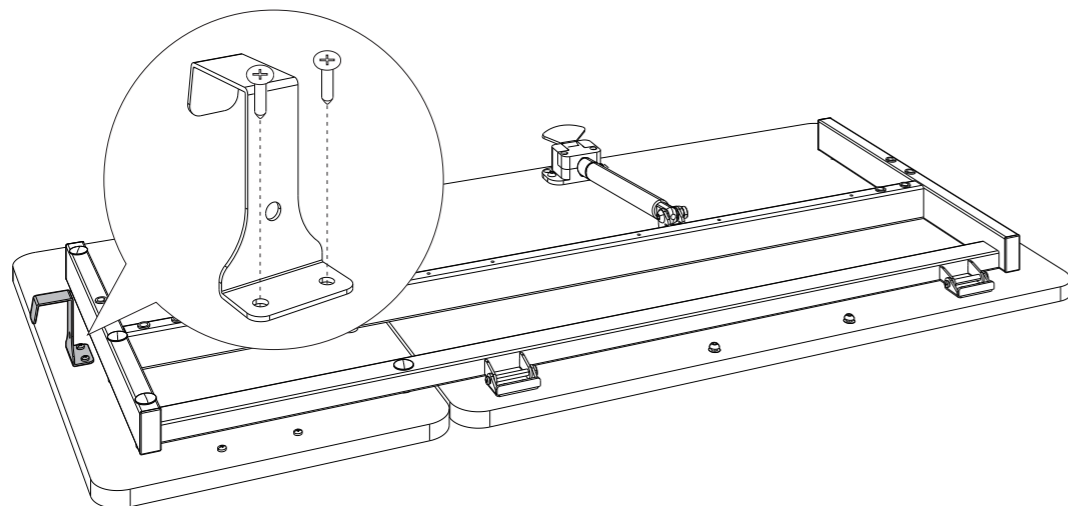
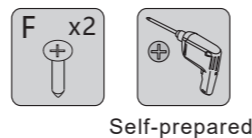

## STEP3

Connect the motor to the right column

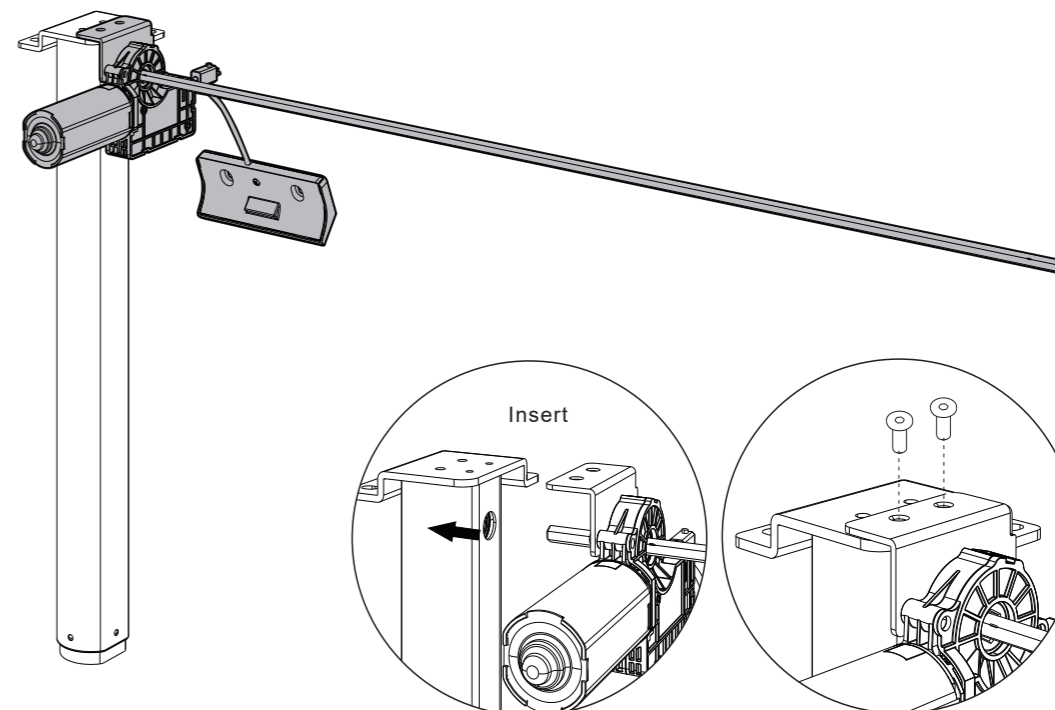
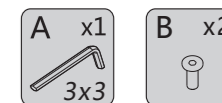

! Ensure the motor is inserted horizontally into the right column

## STEP2

Install the Transmission rod

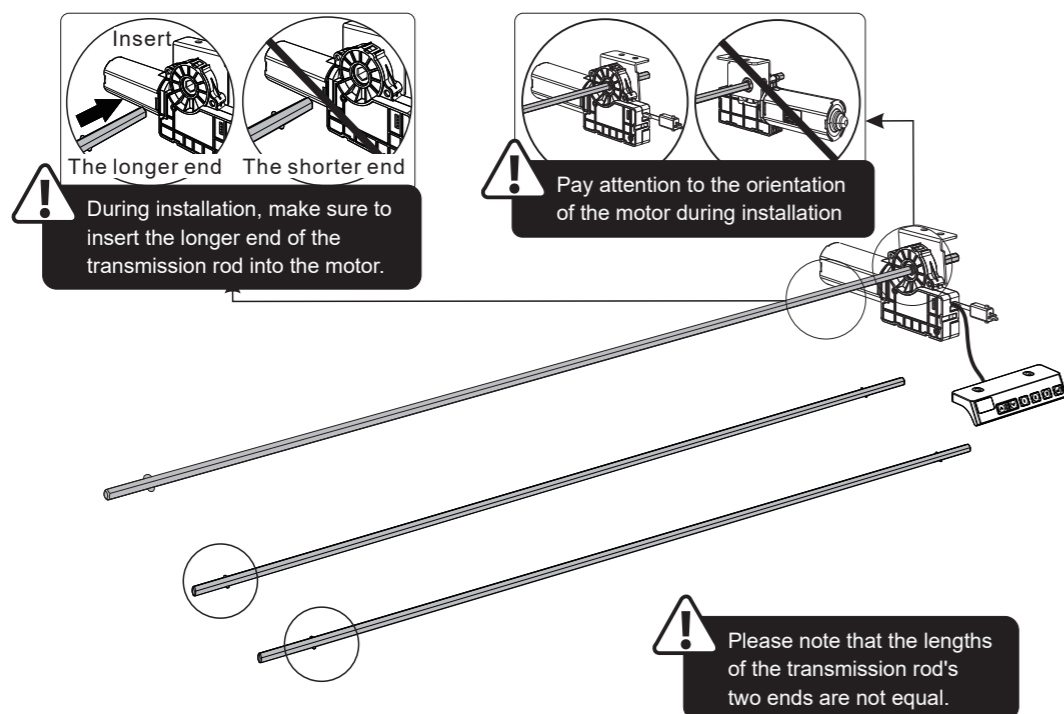

## STEP4

Install the Left column

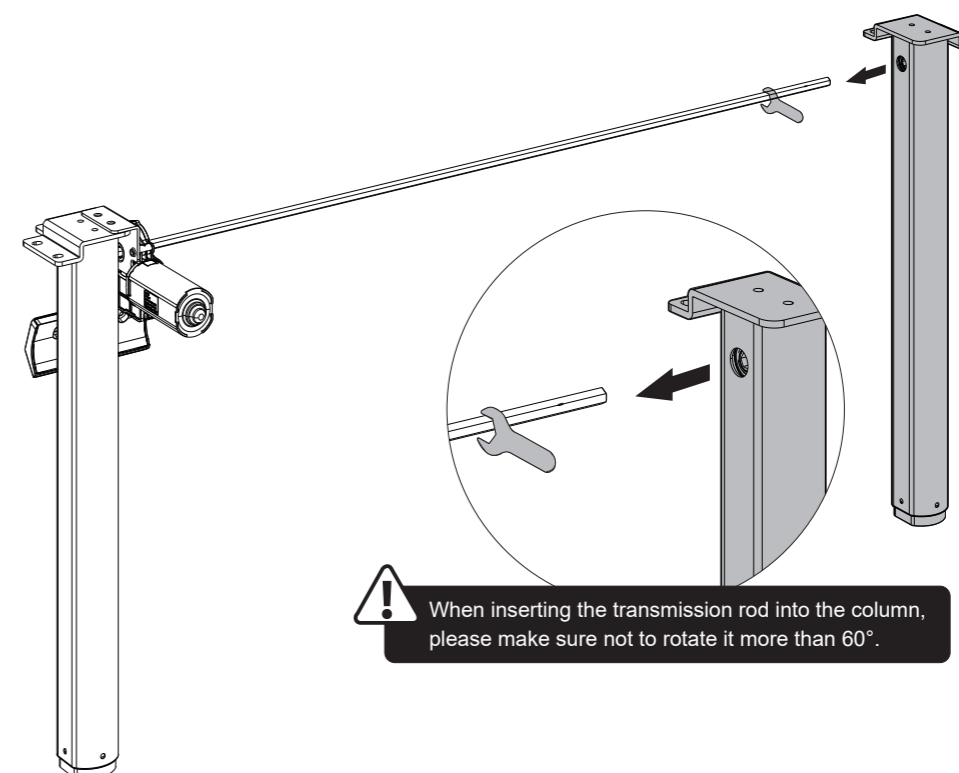

# Assembly Steps

## STEP5

Install the Tabletop

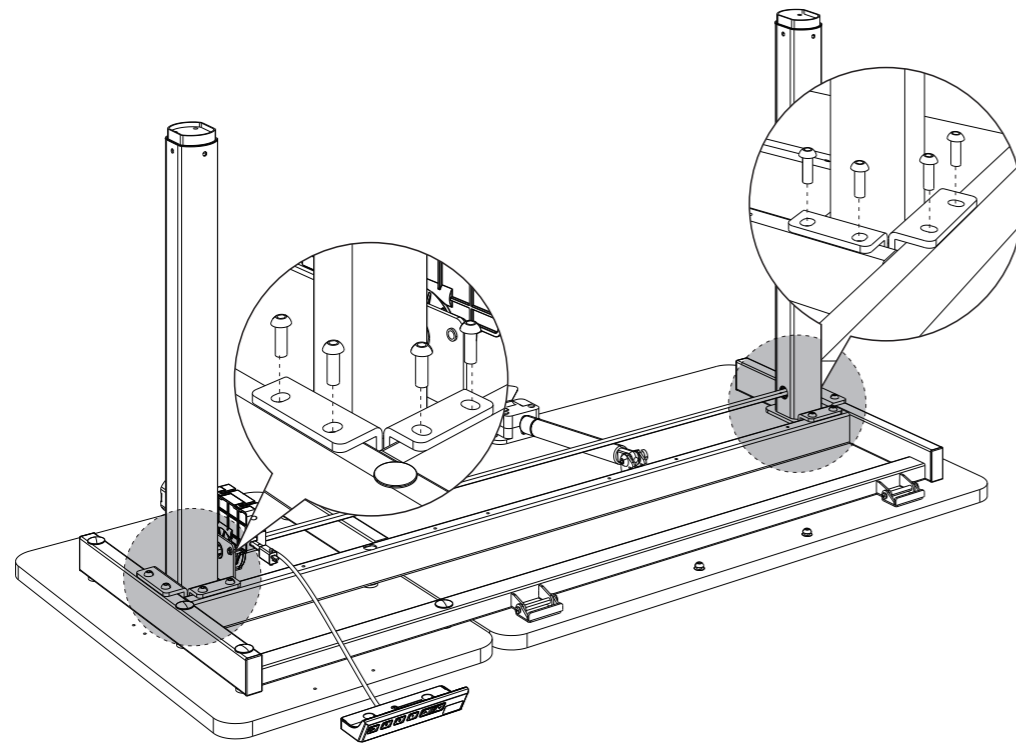

## STEP7

Install the Handset

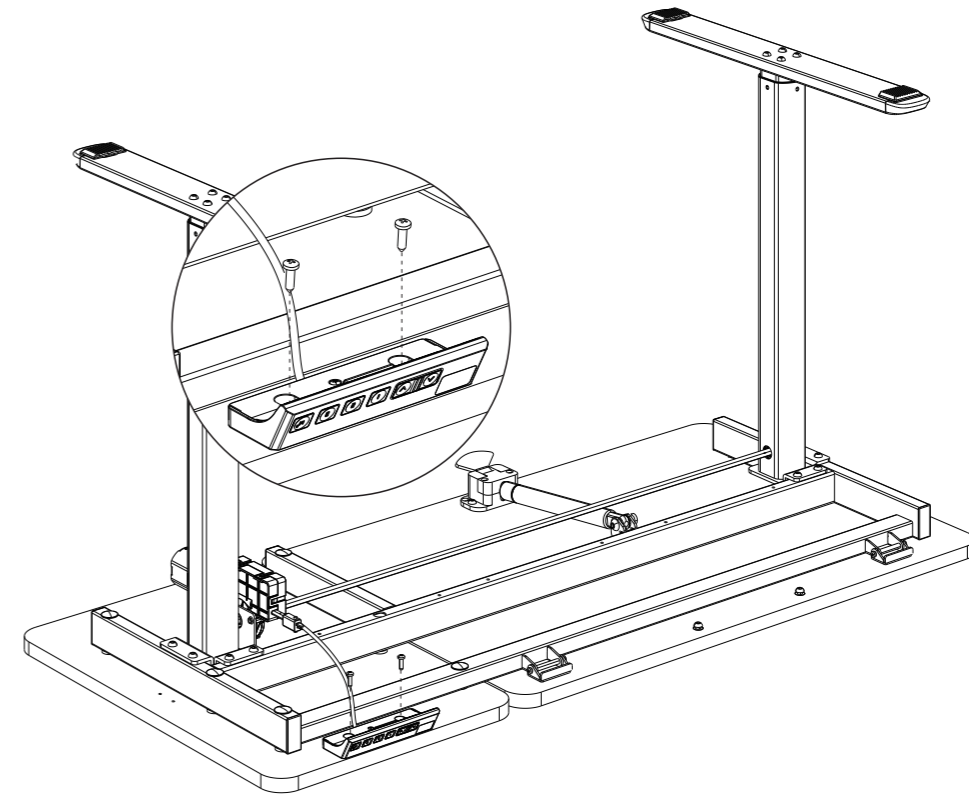
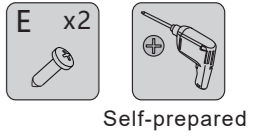

## STEP6

Install the Pedestal

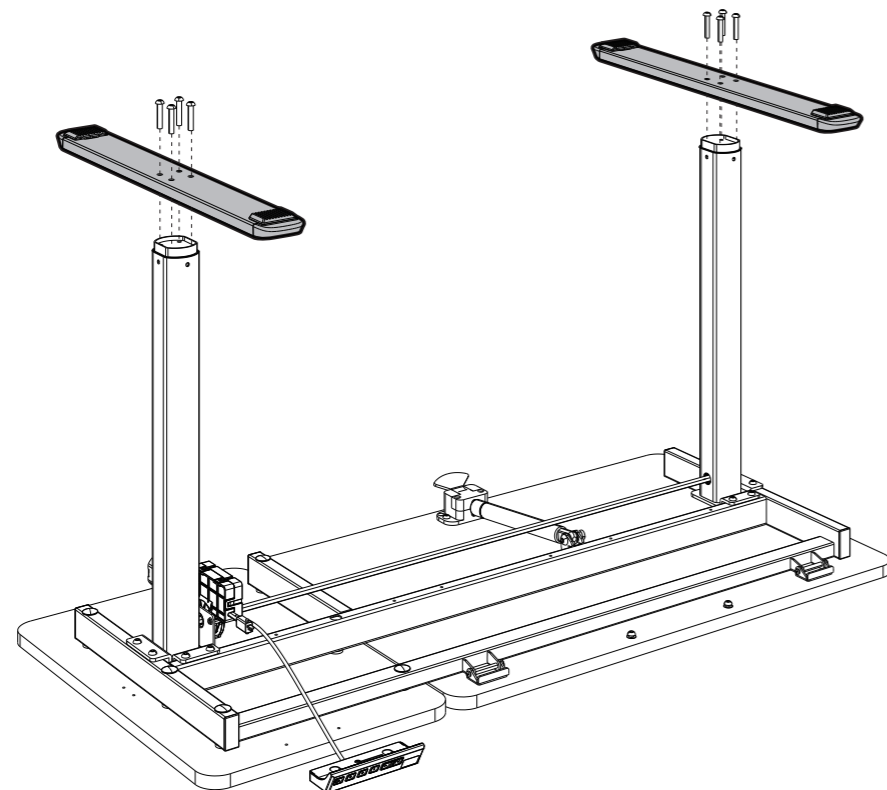
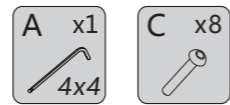

## STEP8

Install the Baffle

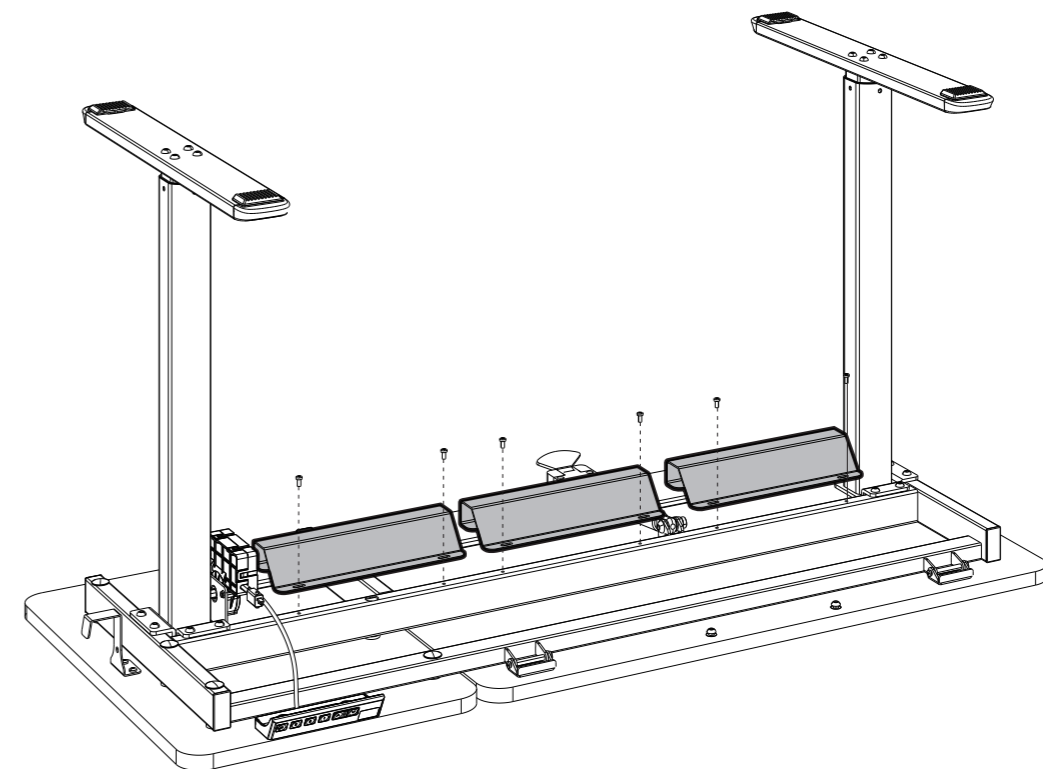
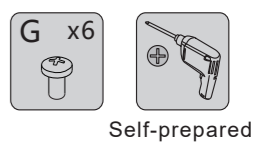

# Assembly Steps

## STEP9

Connect the cables

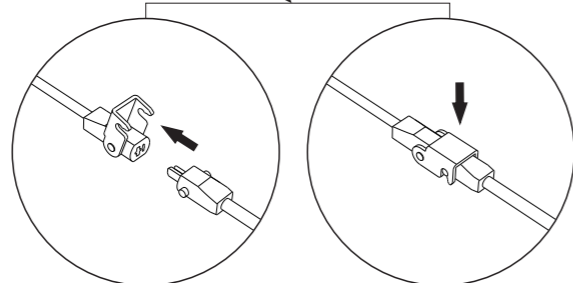
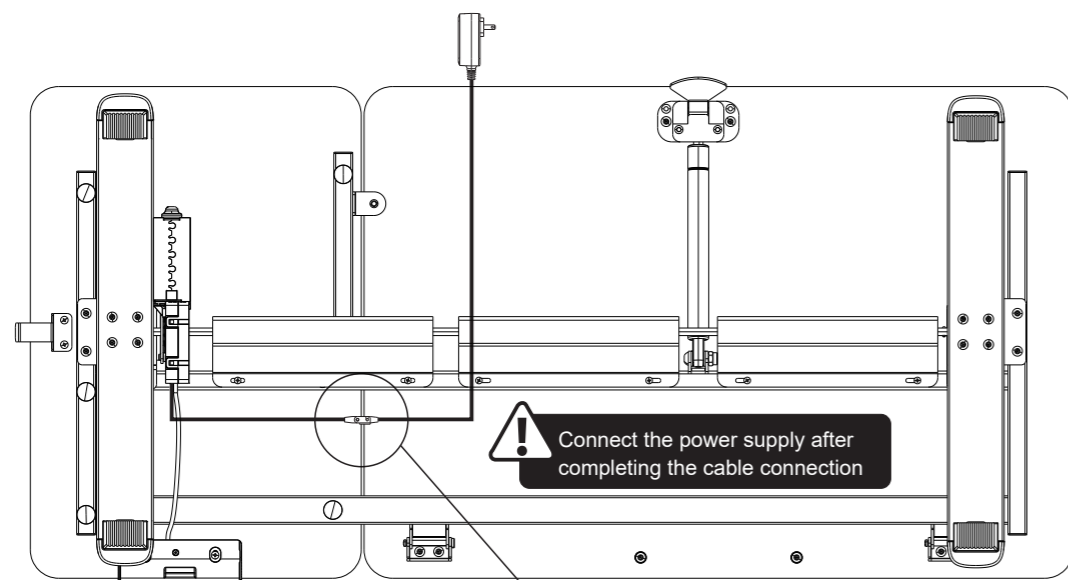

Use Cable clip to secure the various connecting wires to the desktop, keeping the cables tidy.

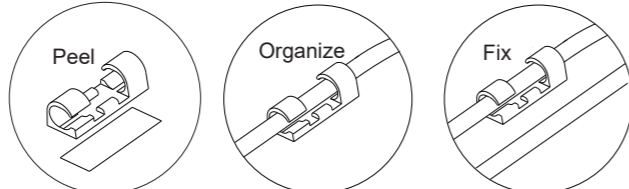

## STEP10

Flip the table

! Please be careful when flipping the table and make sure not to squeeze or damage the handset. Flip the end with the hand control upwards.

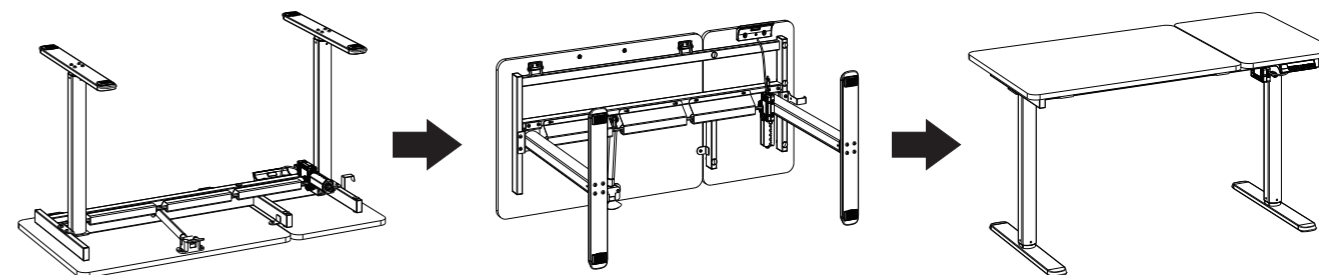

## STEP11

Install the book stopper

A x1  
4x4

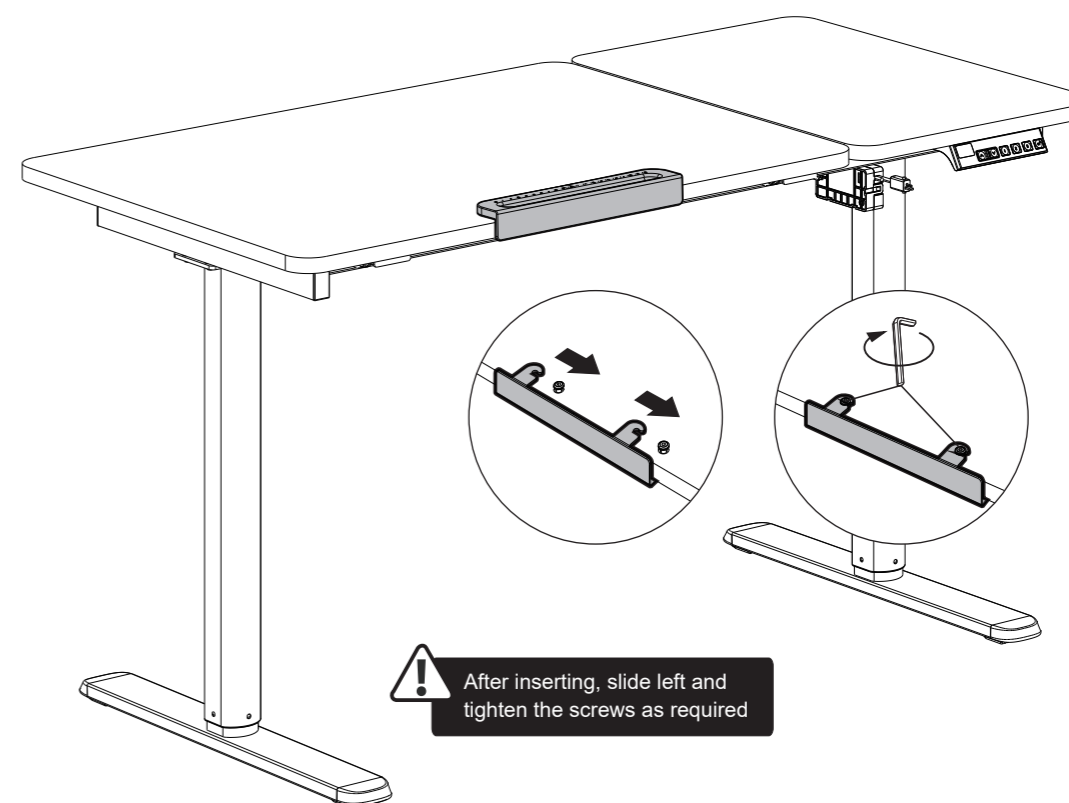

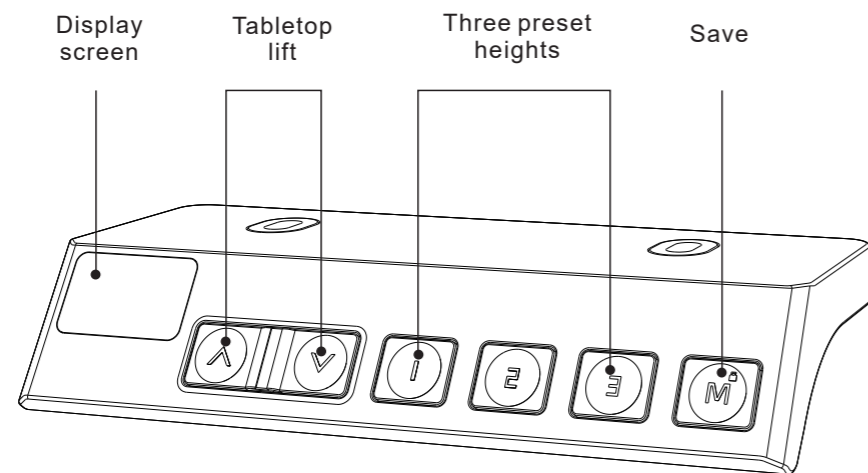

### Note

Ensure that there are no obstacles blocking the movement of the table during the lifting process and confirm that all cables are long enough for the table to move up and down.

### Suggestion

Set the most comfortable height when sitting as "1" and the most comfortable height when standing as "2". Additional preset heights can be freely set to other heights.

## ● Button Control for Height Adjustment

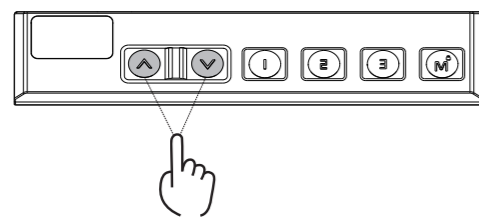

a. By pressing the "▲" or "▼" button, you can adjust the height of the lifting table up or down.

## ● Memory Height Function

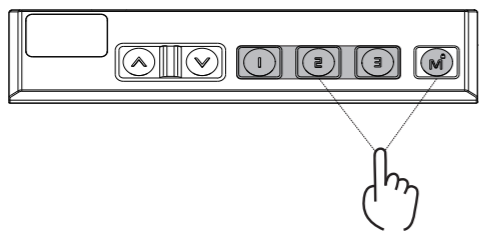

- Press "▲" or "▼" key to adjust the height of the desk to the desired level, press the "M" save button, the display screen will show "5- "; then press the "1" or "2" or "3" key to save the height to position 1 or 2 or 3, and the corresponding display screen will show "5- 1" or "5- 2" or "5- 3".
- Press the "1", "2", or "3" button to automatically adjust the desk to the previously saved position.

## ● Child Lock Function

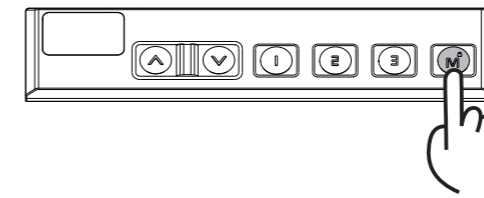

- Hold down the "M" key for more than three seconds to enable or disable the child lock function.
- After activating the child lock function, the screen will display "LoL". At this point, the child lock mode is activated, and all buttons will not function properly. The buttons will only resume normal operation once the child lock function is deactivated.

## ● Adjusting Collision Sensitivity

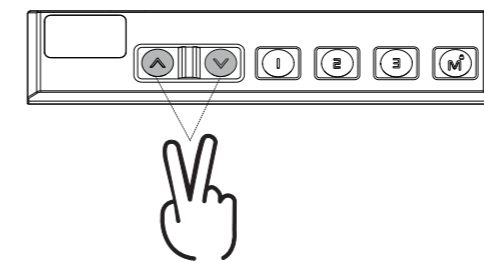

- There are four position in total. When the lifting system encounters obstacles, this function is triggered to reverse the protection.
- Press the "▲" and "▼" keys for three seconds at the same time to switch sensitivity, operate once to switch one level, total divided into four levels, R-1, R-2, R-3.
- The display shows "R-0" means close anti-collision function. The display shows "R-1" low sensitivity; The display screen shows the sensitivity of "R-2"; The display displays "R-3" high sensitivity.
- When the adjustable desk is lifting, it will immediately bounce back when encountering obstacles, playing a protective role.

## ● Reset Function

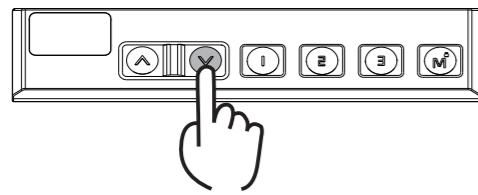
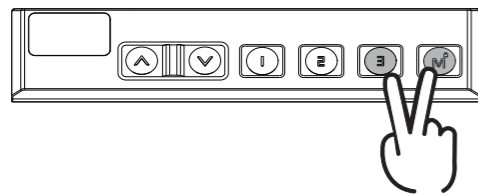
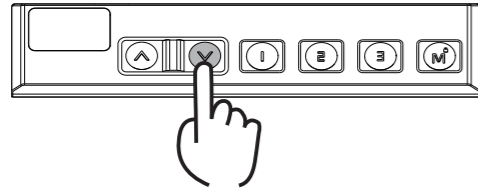

### a. The specific steps to reset

Method 1: Long press the "▼". The table will move to the lowest or highest position and then rebound until it stops. At this time, the display screen will show the height in numbers. Release the "▼" to complete the reset.

Method 2: Press and hold the "M" and "3" keys for 3 seconds to view the software version of the device. Once the viewing is complete, continue to hold the "M" and "3" keys until the LED display shows "r 5t", then release the keys. This will enter the reset mode. To reset, continue to hold the "▼", key until the display shows the current height, then release the down key. The reset is now complete.

### b. If the height adjustment system malfunctions, hold the "▼" button until the desk reaches the lowest position, then release the button. Continue to press and hold the "▼" button until the screen displays the current height, then release the "▼" button to complete the reset.

## ● Error Code Processing

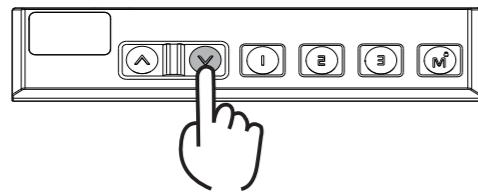

- If the display shows "E01" or "E02", please allow the table to rest for at least 18 minutes before using it again.
- If there are other error codes and pressing the "▼" key does not respond, please check that the connecting cable is not damaged and properly connected. Disconnect the power for at least 10 seconds, then reconnect it. The screen will display "r 5t". Press and hold the "▼" key to reset.
- If the desk still does not function properly after performing the above steps, please contact customer service for assistance.

## ! Precaution

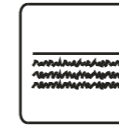

Please place it on a flat surface while using it.



The product is suitable for ages 7 and above.



Warning! Watch out for pinch hazards.



Attention! Adults only should install, keep children away.



Do not sit or put pressure on the table. Please do not place heavy objects on it.

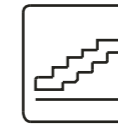

Warning! Do not stand on the table or use it as a step or ladder.



Danger! Do not play with frequent lifting and lowering.

## Resolving Common Issues

This list is used for checking and solving faults and errors. Please contact the manufacturer if problem you encounter is not on the list below.

Problem	Solution
The electronic functions are unable to operate properly	Check the cable connection
Speed of lifting is slow	Check if the load weighs more than 50 kg
The worksurface slides downward	
The device often enters the reset state	
Only descending, not ascending, or only ascending, not descending	Perform a reset operation
Insufficient height for ascending and descending	
The bottom cannot rise	
After exceeding the working duty cycle requirements (Duty cycle: Max 2min on/18min OFF)	Power off for 18 minutes and then reconnect the power
When pressing the down key, the device goes up instead	Check if there are any obstacles or hanging cables under the table

## Attention

1. Power supply: AC100V-240V, frequency 50/60Hz.
2. Operating environment: Indoor, 0-40° .
3. Before cleaning, make sure to unplug the power cord. Use a slightly damp cloth to wipe away surface dust, taking care not to let water drip into the internal components or damage the connection wires. Regularly check if screws are loose and tighten them if necessary.
4. The electrical box contains electronic components, metals, plastics, wires, etc. Dispose of it according to the environmental regulations of your country, not as regular household waste.
5. Before using the product, carefully inspect and ensure that it has been correctly installed. Use only the accessories provided by the manufacturer for installation. Leave adequate safety clearance when placing the product to avoid pinch hazards.
6. Before first use, familiarize yourself with all the functions and program settings of the product.
7. Children are not allowed to play on this product. Certain unpredictable behaviors may result from children playing on the product, and the manufacturer will not be responsible for any resulting accidents.
8. Slight noises from the multi-belt or brake system caused by the structure will not affect the use of the equipment.
9. The use of corrosive or abrasive materials for cleaning equipment is prohibited. Make sure that the cleaning agents used will not contaminate the environment.
10. Operate the equipment only after understanding the relevant hazards. Children under the age of 14 or individuals with physical or sensory impairments or mental disabilities should use the equipment under proper supervision and guidance. Children should not have unattended access to the product.
11. Children should not perform cleaning and user maintenance without supervision.
12. In case of power cord damage, it must be replaced by the manufacturer or relevant professionals to avoid injury.
13. Ensure that your operating environment is free of any potential hazards, such as not littering tools. Always handle packaging materials with caution to avoid various potential dangers, such as the choking hazard posed by children playing with plastic bags.
14. When moving the product, ensure that there are no items placed on the table, the drawers and doors are closed securely, screws are tightened, and the power plug is unplugged. Use at least 2 people for moving. If necessary, keep the original packaging for future transportation.
15. When storing for a long time, unplug the power cord and clean out any loose objects. Store it in a cool and dry place.
16. This product contains small parts that can pose a choking hazard if swallowed accidentally. Keep these small accessories away from children.



## Waste disposal

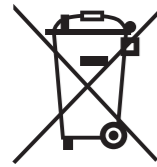

This marking indicates that this product should not be disposed with other household wastes. To prevent possible harm to the environment or human health from uncontrolled waste disposal, recycle it responsibly to promote the sustainable reuse of material resources. To return your used device, please use the return and collection systems or contact the retailer where the product was purchased. They can take this product for environmental safe recycling.